

Wohnung EG
Seehausen

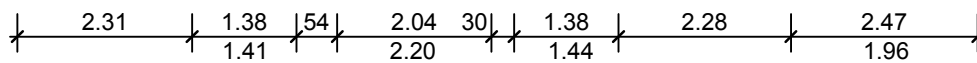

Gartenterrasse

Planverfasser:
Dipl.-Ing. Heiner Köster
Planungs- u. Ingenieurbüro
Dannenberger Str. 12, 28879 Grasberg
Tel.: 04208-2059, Fax: 3377

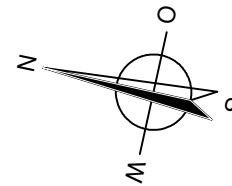
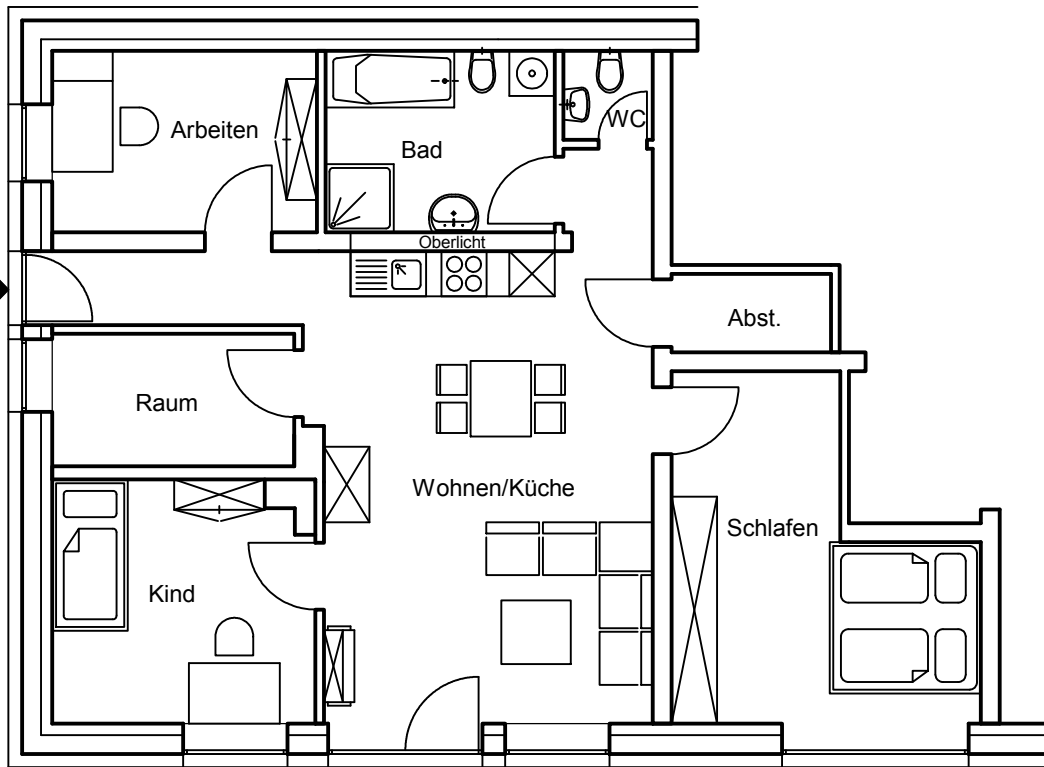
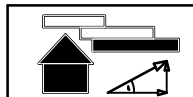

Bauherr:
Karl-Heinz Busch, Seehauser Str. 31, 28879 Grasberg
Quelle: www.Mietwohnung-Grasberg.de Tel. 0 42 08 - 25 58

Bauort:
Mühlendamm 11, 28879 Grasberg

Baumaßnahme:
Revitalisierung Jan Reiners Villa

Planinhalt:
Grundriss Wohnung "Seehausen" Erdgeschoss

gez. Irm	Blattformart DIN A4	Datum 24.01.2013	Projekt - - -	Maßstab 1: 100	Blatt 3
-------------	------------------------	---------------------	------------------	-------------------	------------